

EN

OPERATING MANUAL
AIR WASHER



Table of contents

Notes regarding the operating manual..... 2

Safety 2

Information about the device..... 4

Transport and storage..... 5

Assembly and installation..... 5

Operation 6

Available accessories..... 7

Errors and faults 8

Maintenance 8

Technical annex..... 11

Disposal 11

Notes regarding the operating manual

Symbols



Warning of electrical voltage

This symbol indicates dangers to the life and health of persons due to electrical voltage.



Warning

This signal word indicates a hazard with an average risk level which, if not avoided, can result in serious injury or death.



Caution

This signal word indicates a hazard with a low risk level which, if not avoided, can result in minor or moderate injury.

Note

This signal word indicates important information (e.g. material damage), but does not indicate hazards.



Info

Information marked with this symbol helps you to carry out your tasks quickly and safely.



Follow the manual

Information marked with this symbol indicates that the operating manual must be observed.

You can download the current version of the operating manual and the EU declaration of conformity via the following link:

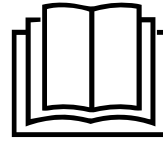

AW 20 S



<https://hub.trotec.com/?id=42938>

Safety

Read this manual carefully before starting or using the device. Always store the manual in the immediate vicinity of the device or its site of use!



Warning

Read all safety warnings and all instructions.

Failure to follow the warnings and instructions may result in electric shock, fire and / or serious injury.

Save all warnings and instructions for future reference.

This appliance can be used by children aged from 8 years and above and persons with reduced physical, sensory or mental capabilities or lack of experience and knowledge if they have been given supervision or instruction concerning use of the appliance in a safe way and understand the hazards involved.

Children shall not play with the appliance. Cleaning and user maintenance shall not be made by children without supervision.

- Do not use the device in potentially explosive rooms.
- Do not use the device in aggressive atmosphere.
- Set the device up in an upright and stable position.
- Fill the device with fresh drinking water only.
- Never insert any objects or limbs into the device.
- Do not cover or transport the device during operation.
- This appliance is not a toy! Keep away from children and animals. Do not leave the device unattended during operation.
- Ensure that all electric cables outside of the device are protected from damage (e.g. caused by animals). Never use the device if electric cables or the power connection are damaged!
- Insert the mains plug into a properly secured mains socket.
- Observe the device's power input, cable length and intended use when selecting extensions to the power cable. Completely unroll extension cables. Avoid electrical overload.

- Before carrying out maintenance, care or repair work on the device, remove the mains plug from the mains socket. Hold onto the mains plug while doing so.
- Switch the device off and disconnect the power cable from the mains socket when the device is not in use.
- Do not under any circumstances use the device if you detect damages on the mains plug or power cable. If the supply cord is damaged, it must be replaced by the manufacturer, its service agent or similarly qualified persons in order to avoid a hazard. Defective power cables pose a serious health risk!
- When positioning the device, observe the minimum distances from walls and other objects as well as the storage and operating conditions specified in the Technical data chapter.
- Make sure that the air inlet and outlet are not obstructed.
- Make sure that the suction side is kept free of dirt and loose objects.
- Do not remove any safety signs, stickers or labels from the device. Keep all safety signs, stickers and labels in legible condition.

Intended use

Use the device for humidifying and cleaning indoor air whilst adhering to and following the technical data. The device is suited for humidifying the room air in order to create an agreeable room climate.

Improper use

- Do not place the device on wet or flooded ground.
- Do not place any objects, e.g. clothing, on the device.
- Do not use the device outdoors.
- Do not use the device for the distribution of liquids other than fresh drinking water.
- Do not use the device for removing heavy contaminations from the air.
- Any unauthorised modifications, alterations or structural changes to the device are forbidden.

Personnel qualifications

People who use this device must:

- be aware of the dangers that occur when working with electric devices in damp areas.
- have read and understood the operating manual, especially the Safety chapter.

Maintenance tasks which require the housing to be opened must only be carried out by specialist electrical companies or by Trotec.

Residual risks



Warning of electrical voltage

Work on the electrical components must only be carried out by an authorised specialist company!



Warning of electrical voltage

Before any work on the device, remove the mains plug from the mains socket!
Hold onto the mains plug while pulling the power cable out of the mains socket.



Warning

Dangers can occur at the device when it is used by untrained people in an unprofessional or improper way! Observe the personnel qualifications!



Warning

The device is not a toy and does not belong in the hands of children.



Warning

Risk of suffocation!
Do not leave the packaging lying around. Children may use it as a dangerous toy.



Caution

If the device is knocked over, water will leak from the lower part.
Disconnect the device from the mains to prevent damage to the device caused by dry running.

Behaviour in the event of an emergency

1. Switch off the device.
2. In an emergency, disconnect the device from the mains feed-in: Hold onto the mains plug while pulling the power cable out of the mains socket.
3. Do not reconnect a defective device to the mains.

Information about the device

Description of the device

The device is a 3-in-1 combination device for air purification, humidification and odour elimination.

The device reduces both odours and electrostatic charges and leaves neither limescale nor wet spots.

It comes equipped with a replaceable prefilter for coarse dirt such as animal hair, fluff and house dust. Additionally a HEPA filter can be activated on demand to reduce bacteria and mould growth.

With a humidification performance of up to 750 ml per hour and an air flow rate of up to 228 m³ per hour the device is suitable for rooms sized up to 55 m² or 138 m³.

The water tank has a capacity of approx. 9 litres and comes equipped with a filling level indication. If the water tank is empty, a warning signal will be emitted and the device switches off automatically.

In sensor-controlled automatic operation an intelligent sensor measures the air quality and humidity level. A three-stage light signal indicates the air quality in the room. The relative humidity is also indicated.

All in all, you can select nine different operating modes. What is more, a plasma generator can be activated on demand.

Apart from using the device in automatic mode you can also manually select one of the three fan stages.

The device operates at a low noise level of < 55 dB.

Furthermore, the device comes with a night mode enabling ultra-silent operation at bedtime.

Device depiction

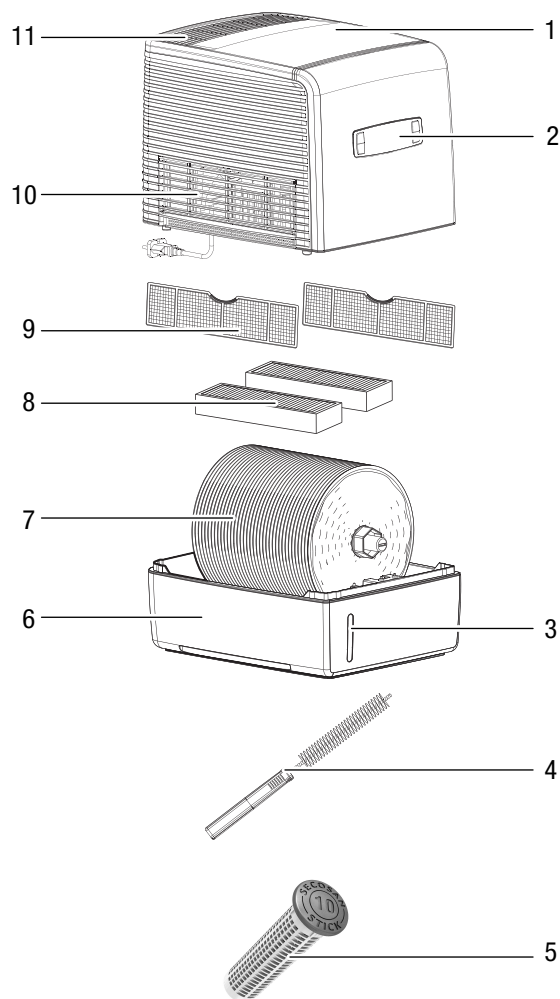

No.	Designation
1	Upper part
2	Control panel
3	Water level indicator
4	Cleaning brush
5	SecoSan® Stick 10 (optional accessory)
6	Bottom section
7	Disk
8	HEPA filter
9	Pre-filter
10	Air inlet with pre-filter flap
11	Air outlet

Transport and storage

Note

If you store or transport the device improperly, the device may be damaged.

Note the information regarding transport and storage of the device.

Transport

Before transporting the device, observe the following:

- Switch off the device.
- Hold onto the mains plug while pulling the power cable out of the mains socket.
- Check whether the upper and lower part of the device are firmly interconnected.
- Lift the device at the lower part.

After transporting the device, observe the following:

- Set up the device in an upright position after transport.

Storage

Before storing the device, observe the following:

- Empty and clean the water tank prior to storage (see chapter Maintenance).
- Hold onto the mains plug while pulling the power cable out of the mains socket.

When the device is not being used, observe the following storage conditions:

- dry and protected from frost and heat
- in an upright position where it is protected from dust and direct sunlight
- with a cover to protect it from invasive dust, if necessary

Assembly and installation

Scope of delivery

- 1 x Device
- 1 x Easy Kit cleaning brush
- 1 x Manual

Unpacking the device

1. Open the cardboard box and take the device out.
2. Completely remove the packaging.
3. Fully unwind the power cable. Make sure that the power cable is not damaged and that you do not damage it during unwinding.

Start-up

- Before restarting the device, check the condition of the power cable. If there are doubts as to the sound condition, contact the customer service.
- Set the device up in an upright and stable position.
- Do not create tripping hazards when laying the power cable or other electric cables, especially when positioning the device in the middle of the room. Use cable bridges.
- Make sure that extension cables are unrolled completely.

Filling the water tank

1. Remove the upper part from the device and put it aside.
2. Remove the packaging from the disk.
3. Lift the disk out of the water tank.
4. Remove further packaging.
5. Refit the disk into the device.
6. Fill the water tank with fresh drinking water.
⇒ The filling level should not exceed the water level line in the water tank.
7. Insert the SecoSan® stick (optional accessory) into the lower part of the water tank.
8. Check whether the distance between the SecoSan® stick and the disk is sufficient. The disk must be able to move freely.
9. Place the upper part onto the water tank.
⇒ The display on the upper part and the logo on the lower part should point in the same direction.
10. Check whether the upper and lower part are properly interconnected as otherwise the device cannot be switched on.
11. Plug the mains plug into a sufficiently fused mains socket.

Operation

Operating elements

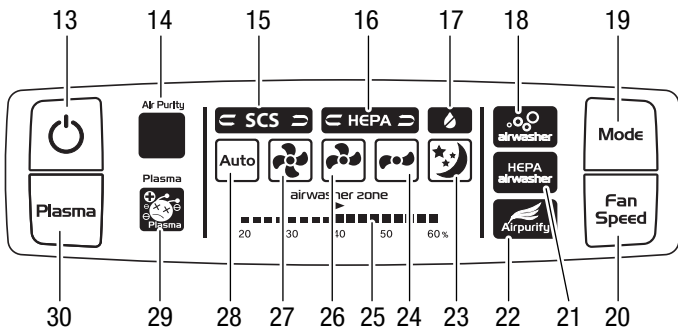

No.	Designation	Description
13	Power button	For switching the device on or off
14	Air purity indication	Indicates the air purity: blue light: high air purity yellow light: medium air purity red light: low air purity
15	SecoSan® stick indication	Illuminated when the SecoSan® stick needs to be replaced.
16	HEPA filter indication	Illuminated when the HEPA filter needs to be replaced.
17	Water tank indication	Illuminated when water has to be refilled.
18	Operating mode humidification indication	Illuminated when humidification mode is activated.
19	Operating mode selection button	For setting the operating mode
20	Fan stage selection button	For setting the fan stage
21	Operating mode humidification with HEPA filter indication	Illuminated when operating mode humidification with HEPA filter is activated.
22	Operating mode air purification indication	Illuminated when air purification mode is activated.
23	Night mode indication	Illuminated when night mode is activated.
24	Fan min indication	The fan runs at minimum speed.

No.	Designation	Description
25	Humidity level indication	Indicates the current room humidity level up to 60 % even if the device switches off at 50 %. <i>airwasher zone</i> = comfort zone between 40 % and 60 %.
26	Fan med indication	The fan runs at medium speed.
27	Fan max indication	The fan runs at maximum speed.
28	Automatic / continuous operation indication	Illuminated when the device runs in automatic / continuous operation.
29	Plasma generator indication	Illuminated when the plasma generator is activated.
30	Plasma generator button	For switching the plasma generator on or off

Switching the device on

Once you have completely installed the device as described in the Start-up chapter, you can switch it on.





1. Press the *power* button (13).
⇒ The device switches on.

Setting the operating mode

Operating mode	Description	Indication
Humidification	The room air is humidified continuously.	
Humidification with HEPA filter	The room air is humidified continuously. Additionally the air is cleaned by the HEPA filter.	
Air purification	The room air is cleaned.	

Setting the fan stage

The following table shows an overview of the fan stages:

Operating mode	Description	Indication
Auto	Fan speed control depending on room humidity. When reaching a humidity level of 50 %, the device stops. It continues to operate as soon as the measured humidity level falls below 50 %.	
Night mode	The device runs in night mode. The LED illumination of the control panel is dimmed. The fan runs at the lowest speed. When reaching a humidity level of 50 %, the device stops. It continues to operate as soon as the measured humidity level falls below 50 %.	
Fan max	The fan runs at the highest speed, regardless of the room humidity.	
Fan med	The fan runs at medium speed, regardless of the room humidity.	
Fan min	The fan runs at the lowest speed, regardless of the room humidity.	

- Press the *fan stage* selection button (20) until the desired fan stage is set.
⇒ The corresponding indication is illuminated.

Switching the plasma generator on or off

The plasma generator can be switched on or off as needed.

- Press the *plasma generator* button (30) to switch the plasma generator on or off.
⇒ If the plasma generator is switched on, the *plasma generator* indication (29) is illuminated.
⇒ If the plasma generator is switched off, the illuminated *plasma generator* indication (29) goes out.

Adding water

If the *water tank* indication (17) is illuminated, you have to refill water.

Note:

After approx. one week of operation, the water tank should be cleaned before refilling with fresh drinking water. Further information on cleaning the water tank can be found in the chapter Maintenance.

- Press the *power* button (13).
⇒ The device switches off.
- Remove the mains plug from the mains socket.
- Remove the upper part from the water tank.
- Fill the water tank with fresh drinking water.
⇒ The filling level should be below the filling level line in the water tank.
- Check whether the (optional) SecoSan® stick is correctly positioned inside the water tank.
- Place the upper part onto the water tank.
⇒ The display on the upper part and the logo on the lower part should point in the same direction.
- Check whether the upper and lower part are properly interconnected as otherwise the device cannot be switched on.
- Plug the mains plug into a sufficiently fused mains socket.
- Press the *power* button (13).
⇒ The device switches back on.

Shutdown

- Hold onto the mains plug while pulling the power cable out of the mains socket.
- Empty and clean the water tank.
- Remove the SecoSan® stick, if necessary.
- Clean the upper louvres according to the Maintenance chapter.
- Store the device according to the Storage chapter.

Available accessories

Designation	Article number
SecoSan® Stick 10	6.100.004.110

Errors and faults

The device has been checked for proper functioning several times during production. If malfunctions occur nonetheless, check the device according to the following list.

The device does not start:

- Check the power connection.
- Check the power cable and mains plug for damage.
- Check the on-site fusing.
- Check whether the upper and lower part are properly connected to one another.
- Wait for 10 minutes before restarting the device. If the device is not starting, have the electricians checked by a specialist company or by Trotec.

Water is leaking:

- Check whether the device is set up in a stable and upright position.
- Check the device for leaks.

Note

Wait for at least 3 minutes after maintenance and repair work. Only then switch the device back on.

Your device still does not operate correctly after these checks?

Please contact the customer service. If necessary, bring the device to an authorized specialist electrical company or to Trotec for repair.

Maintenance

Activities required before starting maintenance



Warning of electrical voltage

Do not touch the mains plug with wet or damp hands.

- Switch the device off.
- Hold onto the mains plug while pulling the power cable out of the mains socket.

Cleaning the housing

Clean the housing with a soft, damp and lint-free cloth. Ensure that no moisture enters the housing. Protect electrical components from moisture. Do not use any aggressive cleaning agents such as cleaning sprays, solvents, alcohol-based or abrasive cleaners to dampen the cloth.

Cleaning the water tank and replacing the (optional) SecoSan® stick

Clean the water tank at least once a week and prior to every start-up or shutdown.

- ✓ The device is switched off and disconnected from the mains.
 - ✓ The upper part of the device has already been removed from the device.
1. Take the disk out of the water tank.
 2. If required, take the SecoSan® stick out of the water tank.
 3. Discharge the residual water into a drain.
 4. Clean the inside of the water tank with a mild detergent.
 5. Thoroughly rinse the water tank with clear water.
 6. Dry the inside of the tank with a lint-free cloth.
 7. If you want to continue using the SecoSan® stick, rinse it thoroughly with clear water.
 - ⇒ The SecoSan® stick should be exchanged approx. every 6 months. The LED for the SecoSan® stick lights up when an exchange is required. After replacement dispose of the SecoSan® stick properly.
 8. Insert the (new) SecoSan® stick in a corner of the water tank. Make sure not to block the rotating disk.
 9. Refit the disk. Check the disk for complete movability. If necessary, reposition the SecoSan® stick so that the disk can turn freely.
 10. Fill the water tank with fresh drinking water.
 11. Put the upper part back on the device.

If you replaced the SecoSan® stick, the *SecoSan® stick* indication (15) needs to be reset after having switched the device back on:

1. Simultaneously press and hold the buttons *power* (13) and *plasma generator* (30) for approx. 3 s.
 - ⇒ The illuminated *SecoSan® stick* indication (15) goes out.

Cleaning the disk

- ✓ The device is switched off and disconnected from the mains.
 - ✓ The upper part of the device has already been removed from the device.
1. In case of slight soiling, insert the Easy Kit between two of the disks and move it back and forth.

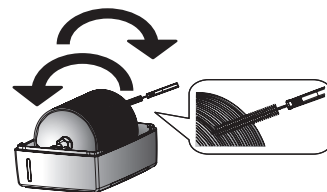

2. In case of heavy soiling, you can disassemble the disk into its individual components and clean them thoroughly:

Disassembling the disk

1. Take the disk out of the water tank.
2. Open the lateral screwing with the Easy Kit or with a coin by turning the cap counter-clockwise.

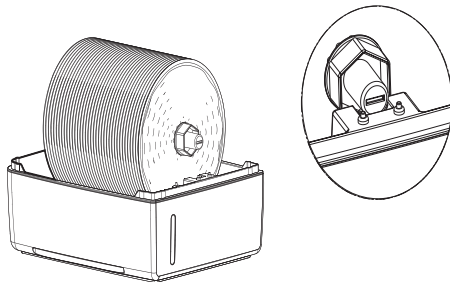

3. Remove the cap.
4. You can take the disks off the shaft and clean them individually.
5. After cleaning, slide the disks back on the shaft.
6. Put the cap back on the shaft and fasten the cap by turning clockwise.
7. Reinsert the disk into the device. Check the disk for complete movability. If necessary, reposition the SecoSan® Stick so that the disk can turn freely.
8. Put the upper part back on the device.

Cleaning the pre-filters

Clean the pre-filters regularly, at the latest when heavy soiling is visible.

Proceed as follows to clean the pre-filters:

- ✓ The device is switched off and disconnected from the mains.
1. Slightly press onto the air inlet louvre on both sides of the device.

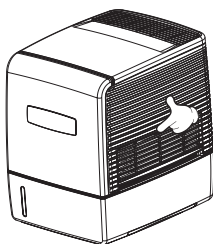

⇒ The louvres open.

2. Fold out the louvres up to the lock position at 45°.

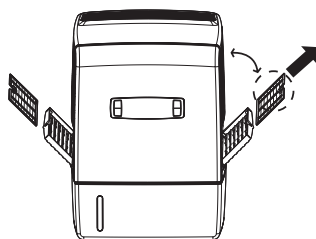

3. Remove the two pre-filters.
4. Clean the pre-filters under fresh water with a soft cloth.

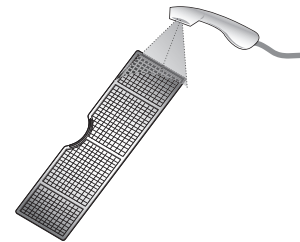

5. Remove the two louvres by carefully pressing them down.

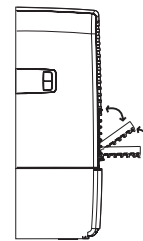

6. Clean the louvres under fresh water with a soft cloth.

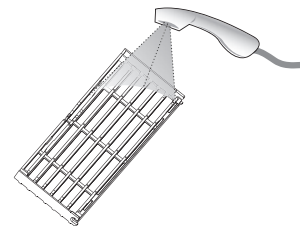

7. Dry the pre-filters and the louvres before refitting them into the device.
8. Reinsert the louvres into the guides and fold up the louvres until they lock in place at approx. 45°.
9. Refit the pre-filters into the guide rail in the louvre.
10. Close the louvres with a snap.

Exchanging the HEPA filters

The HEPA filters should be exchanged in case of heavy soiling. The HEPA filter indication (16) is illuminated if the HEPA filters must be replaced.

When operated in standard air washer mode, the HEPA filters should be replaced approx. every 2 years; in air purification mode, the period is approx. 1 year.

Proceed as follows to exchange the HEPA filters:

- ✓ The device is switched off and disconnected from the mains.
- 1. Remove the upper part from the water tank and place it onto the floor.

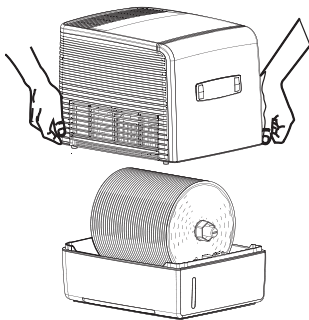

- 2. Turn the upper part around and position it upside down.
- 3. Carefully remove the HEPA filters from the guide rail by pulling at the lug.
- 4. Dispose of the used HEPA filters according to the national regulations.
- 5. Insert the new HEPA filters into the device.

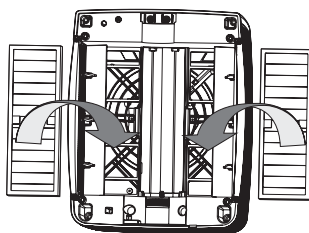

- ⇒ The lugs should point up again.
- ⇒ The HEPA filters should be firmly seated in the guide rails.
- 6. Put the upper part back on the device.
- 7. After switching the device back on, simultaneously press the operating mode button (19) and the fan stage button (20) for approx. 3 s.
- ⇒ The HEPA filter indication (16) is no longer illuminated.

Cleaning the dust sensor

Clean the dust sensor approx. every 6 months.

In very dusty surroundings the dust sensor should be cleaned every 3 months.

Use customary cotton buds for cleaning. You can slightly dampen the cotton buds with water. If you are using damp cotton buds, always wipe dry with a dry cotton bud.

- ✓ The device is switched off and disconnected from the mains.
- 1. Remove the cover from the dust sensor at the rear of the device.

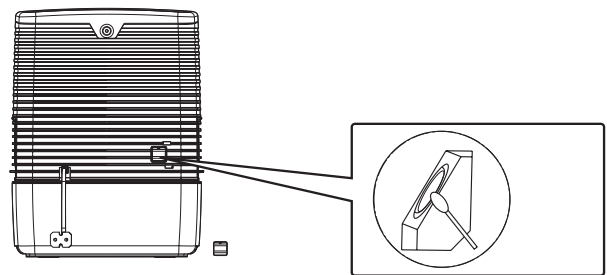

- 2. Carefully wipe over the dust sensor with a cotton bud.
- 3. Reattach the cover to the dust sensor.

Activities required after maintenance

If you want to continue using the device:

- Reconnect the device to the mains.

If you do not intend to use the device for a considerable time:

- Store the device according to the Storage chapter.

Technical annex

Technical data

Parameter	Value
Suitable for rooms sized up to	55 m ² / 138 m ³
Max. humidification performance	750 ml/h
Display of relative humidity	20 % to 60 %
Max. air volume	228 m ³ /h
Mains connection	230 V / 50 Hz
Power consumption max.	24 W
Sound pressure level at a distance of 1 m (max. stage)	47 dB(A)
Water tank	9 l
Dimensions (length x width x height)	410 x 325 x 420 mm
Weight	10 kg
Water filter	SecoSan® Stick 10

Disposal



The icon with the crossed-out waste bin on waste electrical or electronic equipment stipulates that this equipment must not be disposed of with the household waste at the end of its life. You will find collection points for free return of waste electrical and electronic equipment in your vicinity. The addresses can be obtained from your municipality or local administration. For further return options provided by us please refer to our website <https://de.trotec.com/shop/>.

The separate collection of waste electrical and electronic equipment aims to enable the re-use, recycling and other forms of recovery of waste equipment as well as to prevent negative effects for the environment and human health caused by the disposal of hazardous substances potentially contained in the equipment.

Trotec GmbH

Grebener Str. 7
D-52525 Heinsberg

☎ +49 2452 962-400

☎ +49 2452 962-200

✉ info@trotec.com

www.trotec.com